

GALLERY **GH** HOTELES

# GALLERY HOTEL

BARCELONA

## meetings&events



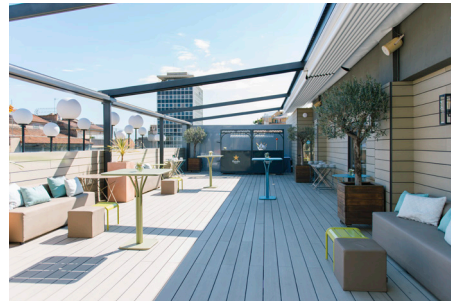





Gallery Hotel le ofrece múltiples espacios para la celebración de eventos y reuniones. Elija entre nuestros 8 salones, cada uno con una personalidad única y con posibilidad de luz natural y sorpréndase con nuestras 2 terrazas privatizables en pleno centro de Barcelona.



*Gallery Hotel offers you a choice of spaces for hosting meetings and events. You can choose from our 8 meeting rooms with a unique personality and with the possibility of natural light and surprise yourself on our 2 outdoor terraces in the heart of Barcelona.*

# Capacidades / Space capacity

## Salones Meeting Rooms

|                       | M <sup>2</sup> |  |  |  |  |  |  |  |  |
|-----------------------|----------------|---|---|---|---|---|---|---|---|
| <b>Ambassador</b>     | 187            | 3,25  | 150   | 200   | 125   | 200   | 55  | 50  | NO  |
| <b>Ambassador I</b>   | 88             | 3,25  | 50  | 70  | 45  | 90  | 35  | 30  | NO  |
| <b>Ambassador II</b>  | 99             | 3,25  | 60  | 100   | 55  | 90  | 35  | 35  | NO  |
| <b>Crillon</b>        | 103            | 2,63  | 77  | 80  | 54  | 88  | 40  | 40  | SI  |
| <b>Crillon-Robert</b> | 142            | 2,63  | 121   | 130   | 78  | 136   | 54  | 56  | SI  |
| <b>Metropol</b>       | 68             | 2,55  | 40  | 40  | 30  | 60  | 25  | 30  | SI  |
| <b>Madison</b>        | 57             | 2,44  | 40  | 30  | 25  | 40  | 25  | 25  | NO  |
| <b>Dover</b>          | 56             | 2,64  | 32  | 30  | 20  | 50  | 15  | 22  | NO  |
| <b>Scotch</b>         | 51             | 2,43  | 50  | 60  | 30  | 60  | 25  | 26  | SI  |
| <b>Robert</b>         | 36             | 2,58  | 36  | 45  | 24  | 40  | 16  | 22  | SI  |

## Espacios exteriores Outdoor spaces

|                        |     |   |   |     |   |     |   |   |    |
|------------------------|-----|---|---|-----|---|-----|---|---|----|
| <b>Sintonia pasaje</b> | 180 | - | - | 150 | - | -   | - | - | SI |
| <b>The Top Events</b>  | 117 | - | - | 120 | - | 100 | - | - | SI |

## Servicios incluidos / Included Services



Aguas minerales  
Bottled mineral water



Material de escritura  
Stationery



Conexión WIFI  
Free WIFI

## Servicios adicionales / Additional Services



Oferta gastronómica  
Gastronomic offer



Equipo de audiovisual  
Audiovisual equipment

Más información / More information:  
gruposg@galleryhoteles.com · galleryhotel.com