



LOCATED IN THE COMMERCIAL AND BUSINESS CENTRE OF THE CITY

5-STAR URBAN HOTEL

INDOOR AND OUTDOOR POOLS

TEN MULTI-USE ROOMS FOR MEETINGS AND EVENTS

| | |
|-------------------------|---|
| LOCATION | In the commercial and business area of Lisbon Just 350 m from the Praça Marquês de Pombal 450 m from Eduardo VII Park 15 minutes from Lisbon airport |
| ACCOMMODATION | With 166 rooms including doubles, junior suites, suites and Presidential Suite Marquês de Pombal |
| FACILITIES AND SERVICES | Outdoor pool Indoor pool with fountains and upright water massages Sun terrace Private parking (\$) Free Wi-Fi International newspapers daily Fitness centre Lounge bar and exclusive terrace with pool access Ten multi-use rooms + Ballroom |
| CUISINE | Buffet restaurant for breakfast À la carte restaurant with local and international cuisine Lobby Bar Pool bar 24-hour room service |
| ENTERTAINMENT | Guided tours of the city Concierge Service: Transfers, Car Hire |



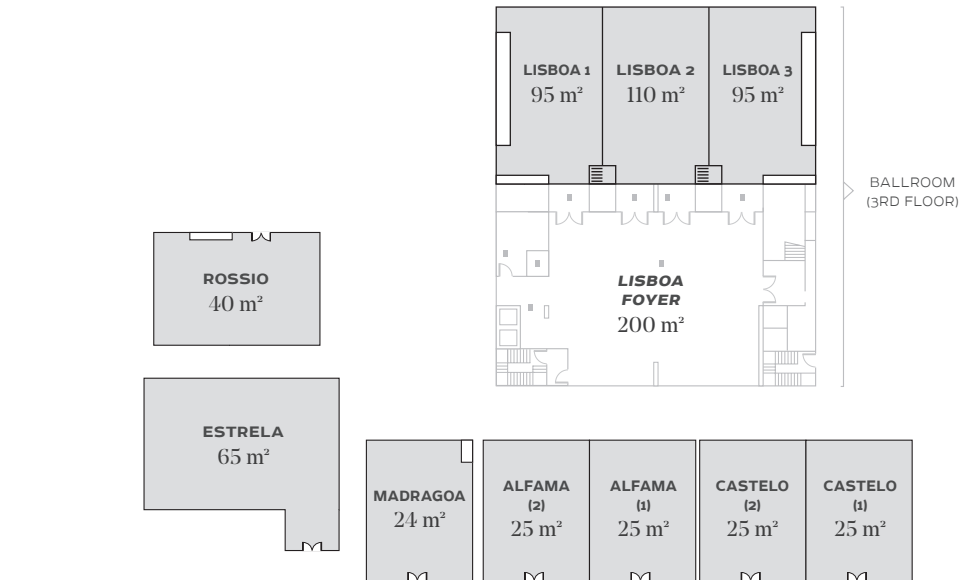

| ROOMS | ESTRELA | ROSSIO | LISBOA (1) + (2) + (3) | FOYER LISBOA | MADRAGOA | ALFAMA (1) + (2) | CASTELO (1) + (2) | BUSSINES CENTER |
|----------------|-----------|--------|---------------------------|--------------------|----------|---------------------|----------------------|--------------------|
| AREA (m²) | 65 | 40 | 95 + 110 + 95 / 300 | 200 | 24 | 25 + 25 / 50 | 25 + 25 / 50 | 32 |
| DIMENSIONS (m) | 8 | 6 | 13.5 | - | 6 | 6 + 6 / 12 | 6 + 6 / 12 | 6 |
| WIDTH (m) | 8 | 6 | 7 + 8 + 7 / 22 | - | 4 | 4 + 4 / 8 | 4 + 4 / 8 | 5 |
| HEIGHT (m) | 2.7 | 2.5 | 6 | - | 2.5 | 2.5 | 2.5 | 2.5 |
| COLUMN | NO | NO | NO | YES | NO | NO | NO | NO |
| NATURAL LIGHT | YES | NO | YES | NO | NO | YES | YES | NO |
| FLOOR | Carpet | Carpet | Parquet | Stoneware | Carpet | Carpet | Carpet | Carpet |
| CAPACITY (PAX) | THEATER | 56 | 34 | 80 + 90 + 80 / 250 | - | 22 | 24 + 24 / 50 | 24 + 24 / 50 |
| | CLASSROOM | 46 | 28 | 60 + 70 + 60 / 190 | - | 18 | 18 + 18 / 36 | 18 + 18 / 36 |
| | U-SHAPE | 27 | 18 | 24 + 24 + 24 / 72 | - | 8 | 8 + 8 / 17 | 8 + 8 / 23 |
| | COCKTAIL | 60 | 40 | 80 + 90 + 80 / 250 | 160 | 25 | 25 + 25 / 50 | 25 + 25 / 50 |
| | BANQUET | 50 | 30 | 60 + 70 + 60 / 190 | - | - | 20 + 20 / 40 | 20 + 20 / 40 |
| | BOARDROOM | 24 | 24 | 34 + 38 + 34 / 106 | - | 10 | 10 + 10 / 20 | 10 + 10 / 20 |

Rooms' main structures
Additional areas (Foyer Lisboa)

Conference area or zone (in m²)
Columns or pillars

TEN CONFERENCE ROOMS (PLUS THE FOYER) WITH A TOTAL CAPACITY OF 461 M²

SPACIOUS AND COMFORTABLE HALL AREA, IDEAL FOR SMALL MEETINGS OR INTERVIEWS

ADAPTABLE, MULTI-FUNCTIONAL BALLROOM TO HOLD THE BEST EVENTS

TERRACE WITH GARDEN AREA, PERFECT FOR OPEN-AIR BANQUETS AND COCKTAIL RECEPTIONS

ELEGANT LOBBY AND BAR AREA TO RELAX IN BETWEEN ACTIVITIES

MICE FACILITIES

Ten conference rooms measuring a total of 461 m² with capacity for up to 490 people
State-of-the-art audiovisual equipment and free Wi-Fi
Multi-functional ballroom measuring 300 m²: rooms can be adapted into 3 areas or remain as one large multi-functional room. 200 m² foyer for welcome cocktails. Cloakroom service

MICE ACTIVITIES

Team building activities (at the hotel): workshops, etc.
Organisation of social events: weddings, banquets, etc.
Organisation of business events: congresses, trade fairs, conferences, etc. Team building activities (at the hotel): workshops, etc.
Organisation of social events: weddings, banquets, etc.
Organisation of business events: congresses, trade fairs, conferences, etc.

MICE SERVICES

Coffee breaks, working lunches, cocktail receptions, gala dinners and themed parties, etc.
Personalised attention and 24-hour reception

PLACES OF INTEREST

11 km from Altice Arena (Pavilhão Atlântico), a covered, multi-functional stadium in Nações Park, with capacity for 16,000 people
11 km from FIL (Lisbon Exhibition and Congress Centre) with capacity for 20,000 people
6.5 km from CCL (Lisbon Congress Centre) with capacity for 2,500 people



E-mail: iberostarmeetings@iberostar.com